

# 3 COAT STUCCO ISOMETRIC DETAIL

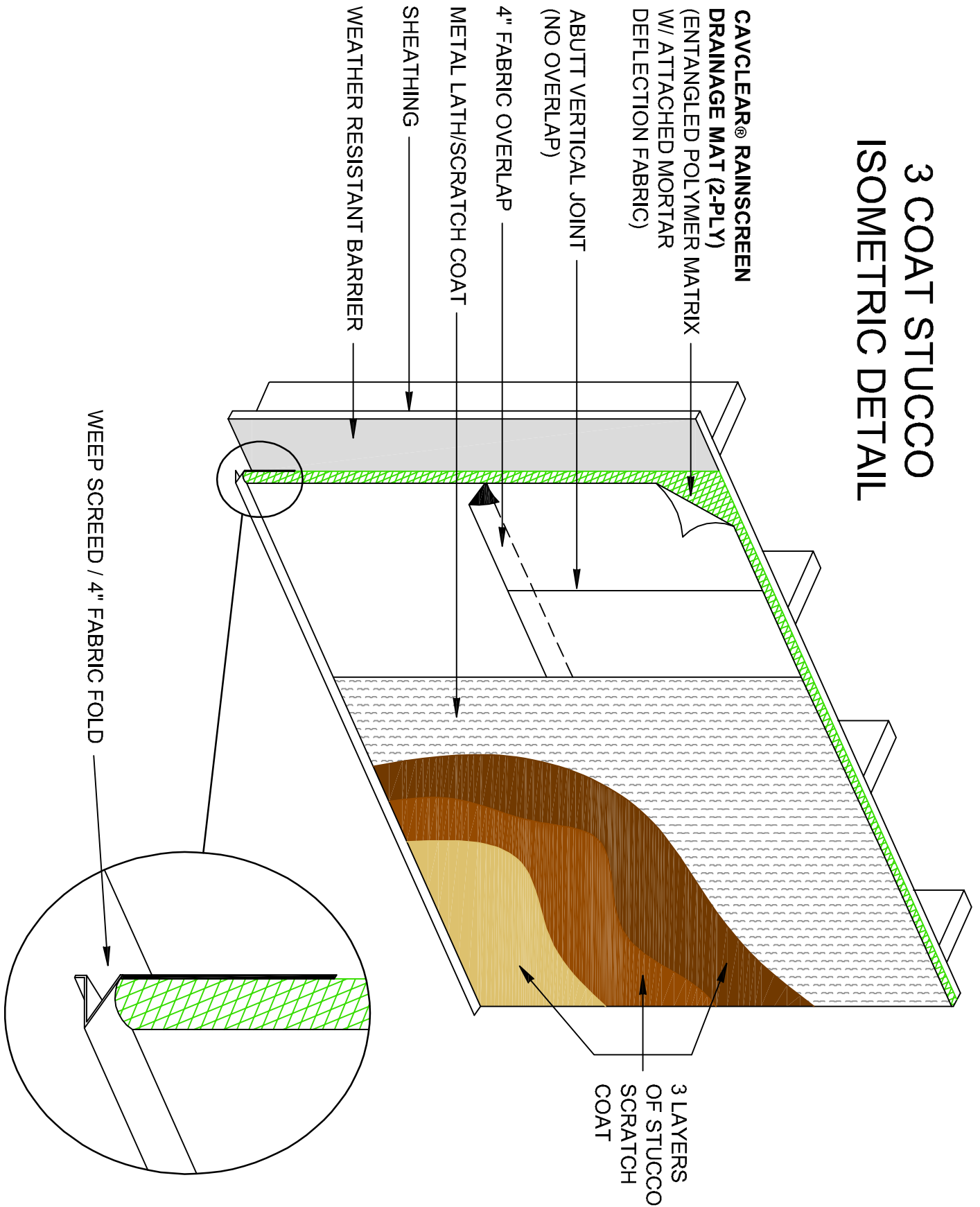

NOTE: CavClear® Rainscreen Drainage Mat (Green) should be installed facing the weather resistant barrier, with the mortar deflection fabric against the metal lath fabric (facing the exterior wall).

The details and graphics as displayed here are for the express purpose of illustrating basic wall design concepts incorporating CavClear® brand products.